



USER GUIDE  
**MS-RS-400**





# PRODUCT SPECIFICATION SHEET

## MUCKSTOPPER RS 400

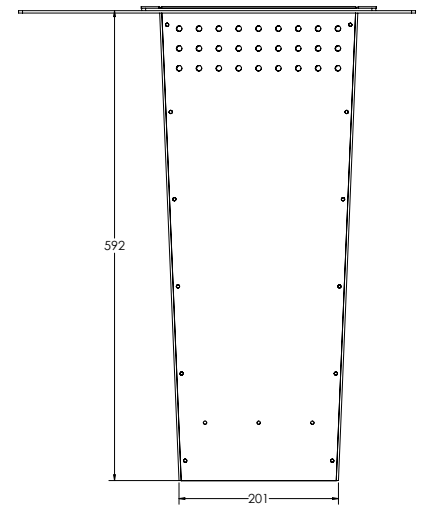
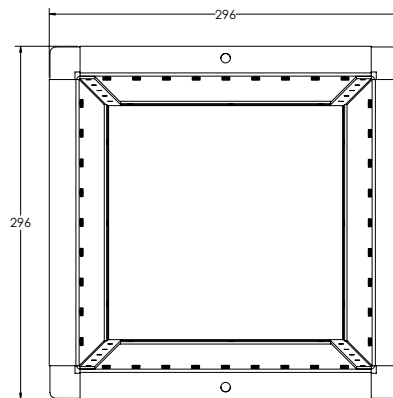

Name  
**MuckStopper RS-400**

Code  
**MS-RS-400**

Description  
**The MuckStopper RS-400 is a removable silt trap bucket with drainage holes at the top. It is designed to be installed in road gullies as a temporary solution during construction. This product offers a first line of defence against silt, catching the majority of it at source.**

Size  
**296mm x 296mm x 592mm**

Weight  
**10KG EMPTY  
60KG FULL**

Lifting capacity  
**100KG**

Material  
**GALVANISED STEEL**

Compatibility  
**Will work with any brand of road gully**

### Overview

We have designed the MuckStopper RS 400 to solve the challenge of mud and silt entering road gullies and clogging the drainage system below. This silt trap protects the surface water drainage system from blockages.

Rugged and easy to fit, we designed MuckStopper RS 400 to be installed beneath the cover and frame of a road gully. It has a large and robust, removable silt bucket to allow for regular emptying removal of silt and dirt.

The MuckStopper can be installed in a concrete road gully using the same process.



# 1

Before installing the gully grating & frame, install the MuckStopper above the brickwork. Bed the MuckStopper frame in place with mortar and ensure it is level. Ensure the narrow side of the frame is against the kerb.



# 2

Place more mortar above the MuckStopper frame and complete the installation of the gully grating and frame per the manufacturer's guidelines above the MuckStopper. During installation of the gully grate, ensure the bucket is positioned correctly for removal.



# 3

During the project carry out routine checks of the MuckStopper and empty any debris that it has collected, keeping the drains free of blockages.



# 4

The MuckStopper should be extracted using machine lift. At the end of the project, the MuckStopper should be removed. The grating and frame can then be re-installed when setting final levels before surfacing as usual.



## USING THE MUCKSTOPPER & ACCESSING THE GULLY

Perform regular checks to monitor silt levels in the MuckStopper bucket and empty before the silt reaches the drainage holes.

## LIFTING WITH AN EXCAVATOR

1. Attach the lifting apparatus to the MuckStopper handle, using a suitably rated certified four leg lifting chain. Always ensure that the hook's gate is correctly closed.
2. Carefully raise and lift the MuckStopper bucket to the designated emptying area.
3. Lower the MuckStopper bucket in the emptying area. While the bucket is still suspended, manually swing the bottom of the bucket up to empty it.

## TRANSPORTING MUCKSTOPPER UNITS WITH A FORKLIFT

Multiple MuckStopper RS 400 units can be transported on a pallet using a forklift, telehandler or excavator forks. Follow typical safe working practices. Individual MuckStopper RS 400 units can be transported by hand, following safe manual handling practices to avoid injury.

## SAFETY INSTRUCTIONS

A site-specific Risk Assessment, and lift plan, where applicable, must be completed by the responsible person before using this equipment to control risks, produce a safe system of work and ensure safety for you, your colleagues and others. Your risk assessment will determine the correct Personal Protective Equipment (PPE) for your task. You must use it. Bluejay Solutions recommends that you should wear:



Hard hat



Protective footwear (steel toecaps)



Safety glasses



Suitable clothing



Gloves

## STORAGE

Store on a suitable flat surface

## IMPORTANT SAFETY NOTES

- Read these instructions before using this equipment. If there is anything you do not understand or if you have any concerns, do not use this equipment. Contact your supervisor or Bluejay Solutions for advice.
- You must check that you have considered all the safety requirements for your task and that this equipment is suitable.
- You must protect bystanders and the general public by preventing access to the working area.

## USAGE & TRANSPORTATION

- Make sure you know how to use this equipment and understand all aspects of its operation.
- Take care in confined spaces, near ceilings or similar hazards. This equipment was designed for vertical lifting. Do not drag or swing.
- Before operating this equipment, check that you have enough space to work safely and make sure that the working area is clear of hazards, obstructions and personnel.
- Before lowering MuckStopper units, make sure that the landing zone is clear and capable of accepting the size and weight of the load.
- Before lifting equipment, check that the load is secured, balanced and stable. Allow space for the equipment to move if the load shifts.
- Manoeuvre loaded or raised equipment carefully. Travel and turn slowly to prevent units from becoming unstable.

## PERSONNEL

- All personnel must wear appropriate personal protective equipment.
- Do not wear loose clothing or jewellery, and tie back long hair to avoid becoming tangled or trapped in this equipment. You must make everyone in the work area aware of your actions.
- All personnel involved in the lifting operation

must be competent to do so and must have been briefed in conjunction with this User Guide available from Bluejay Solutions, the manufacturer.

- Do not use this equipment if you are tired, unwell or under the influence of alcohol or drugs. You should inform your supervisor if you are taking any medication or undergoing treatment.
- All personnel involved in lifting and transporting this product must have read this User Guide and be properly briefed.
- You must be competent, alert and medically fit when using this equipment. If you have a medical condition or a mental or physical disability, you must seek advice from a medical professional before using this equipment.

## **EQUIPMENT MAINTENANCE & CLEANING**

- Remove any excess silt from the MuckStopper RS 400 with a suitable tool. If available, use a pressure washer to remove a build-up of silt from the MuckStopper.
- A competent person must inspect this equipment before each use and then regularly, as determined by your risk assessment or working practice. If you are concerned about its condition or suitability, refrain from using it.

## **MODIFICATIONS**

Modifications and alterations to the product are strictly prohibited.

Bluejay Solutions operates a continuous improvement policy and therefore reserves the right to alter technical specifications and user guide details at any point without notice.

Bluejay Solutions and/or their directors, employees, insurers or recognised agents will not be held liable for consequential damages, losses or expenses relating to the inability to use the product correctly for its purpose.